

Compact separation technology for low-cost installation

Plant technology for various areas of application

Areas oil application

Operations with waste water containing mineral oil (e.g. motor vehicle operations in the areas of service, maintenance, repair; community and military operations; industry and industrial businesses).

Nominal sizes

NG 3 to 100

Components and equipment features

coalescence separation plant (DIN EN 858 Class-I) with:

- Sludge trap (S)
- Coalescence separator (I)
- Sampling shaft (P)

Construction

Special features of BENE QUADRON is the comparatively compact construction type:

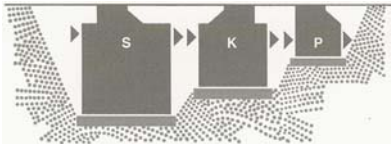

Conventional technology

BENE QUADRON



BENE QUADRON has **four** crucial advantages:

- Compact separator (compact system).
→ little room required
- coalescence separator (class I-separator in accordance with EN 858)
→ high purification performance
- Integrated sludge trap
→ no extra tank
- Integrated sample-taking device
→ no further shaft

Functional description

Separation of oils and light liquids from wastewater. Through gravity (no additional chemicals) with additional purifying through the storage of thinnest oil droplets (dispersion) on the surface of the coalescence material (adsorption). Through unification of those droplets (coalescence) the oil rises up to the surface of the separators. This is where the separated oil is stored.



Construction type

Outside coating made of high-quality, supervised and water-resistant steel concrete B45 (monolithic prefabrication). Build-in units made of corrosion-resistant materials (stainless steel and other special materials). The inside surfaces of the steel concrete tank are treated with light liquids resistant coating or they can optional be lined with HDPE.

Please check if there is a different Bene product more suitable for your requirements (e.g. two-stage plant design, filterless coalescence stage, oil separation device, storage supervision system etc.).

Text of bids

S-I-P-coalescence separator plant BENE QUADRON,
DIBt, No.: Z- 54.8- ____
Subject of approval:
Coalescence separator (DIN EN 858, Class-I-separator) with integrated sludge trap and sample taking device
Nominal size / Sludge trap / oil storage
= ____ / ____ / ____

- Oil storage minimum: ____ l,
- Total Volume that has to be disposed: maximum ____ l,
- Height difference between inlet and outlet maximum 2 cm.

Outside coating made of reinforced concrete B 45, according to DIN 4281, internal construction made of stainless steel or other special material.

Tarring for light liquids with density of ____ g/cm³
Inflow depth Z = ____ m
Pipe connections EN 295 DN ____ (mm)
Maximum single weight: ____ to Class D
Cover

Announced make:
BENE Separa, D-77855 Achern
Tel. +49 7841 2045-0
Fax +49 7841 2045-301
info@bene.de
www.bene.de
or equivalent.
Offered make:

(Should here stand no product from the tenderer, then the bidden make is valid as inserted.)

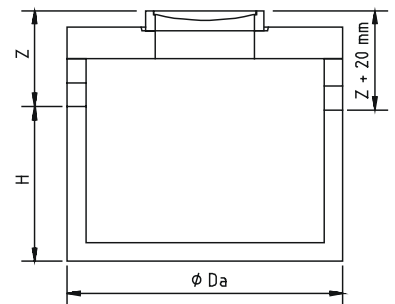

Nominal size	NG	3	3-10	3-10	3-10	15	15	20	20	20	30	30	30	40	40	50	50	65	65	80	80	100	100
Sludge trap volume	[l]	650	2500	5000	7000	3000	5000	2500	4000	6000	3000	6000	9000	4000	7000	5000	10000	6500	13000*	8000**	16000**	10000**	20000**
Oil storage	[l]	523	656	885	885	875	875	875	875	1092	1092	1092	760	760	4820	1800	4200	2420	4010	4290	4290	2470	
Outside diameter Da	[mm]	1440	1740	2240	2240	2240	2240	2240	2240	2800	2800	2800	2800	2800	2800	2800	2800	2800	2800	2800	2800	2800	
Input & output diameter	[mm]	150	150	150	150	200	200	200	200	200	250	250	250	300	300	300	300	300	300	400	400	400	400
H	[mm]	1340	1990	1870	2770	1820	2020	1220	1820	2420	1770	2270	2770	2270	2270	2220	2720	2470	2720	2470	2720	2720	2720
Inflow depth (standard)* Z	[m]	0,70	0,70	0,75	0,75	0,75	0,75	0,75	0,75	0,75	0,80	0,80	0,80	0,85	0,85	0,85	0,85	0,85	0,85	0,95	0,95	0,95	0,95
Maximum single weight	[to]	2,34	3,89	5,56	6,90	5,38	5,81	4,36	5,48	6,45	8,03	9,45	10,8	9,75	11	10,1	11,57	10,84	11,57	10,92	11,65	11,65	11,65
Total weight	[to]	3,10	5,25	7,52	8,80	7,34	7,77	6,32	7,44	8,45	12,2	13,2	14,7	13,6	15,1	14,1	15,57	14,84	15,57**	14,92**	15,65**	15,65**	15,65**
DIBt-approval: Z-54.8-		121	121	121	121	121	121	121	121	121	121	121	121	121	121	351	317	351	352	352	352	352	352

Other supply sizes on request

* Take note of local frost-free depth! Our project installation drawings apply in the case of construction measures.

**To achieve the volume of the sludge collector there must be an additional sludge collector installed in front of the separator.

All rights for technical changes reserved. Status date 09-09-04.